

# K 17 – K17/C

---

**Compressori monostadio / Single-stage compressors**  
**Compresseurs à un étages / Einstufige Kompressoren**

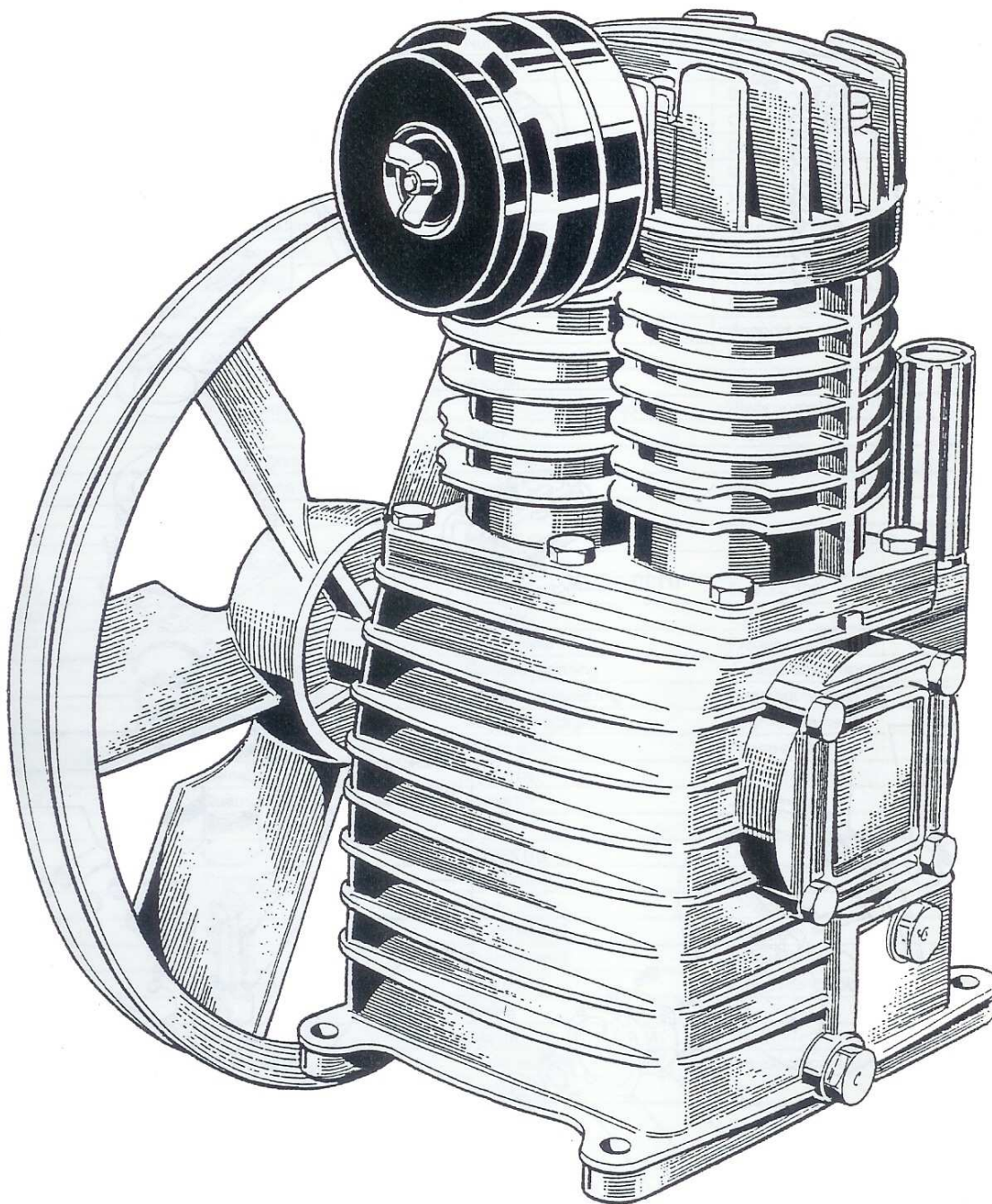

# ESPLOSO DEI GRUPPI K17-K17C

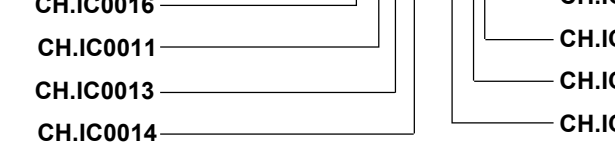
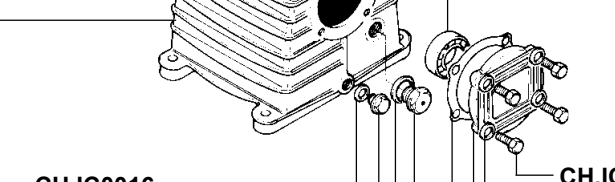
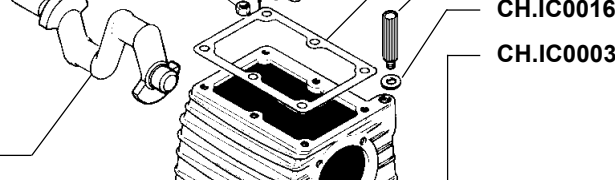
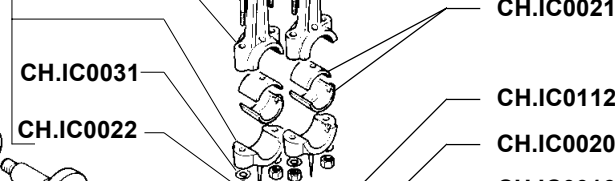
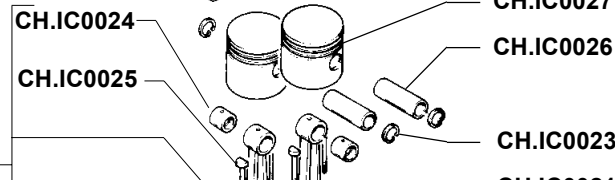
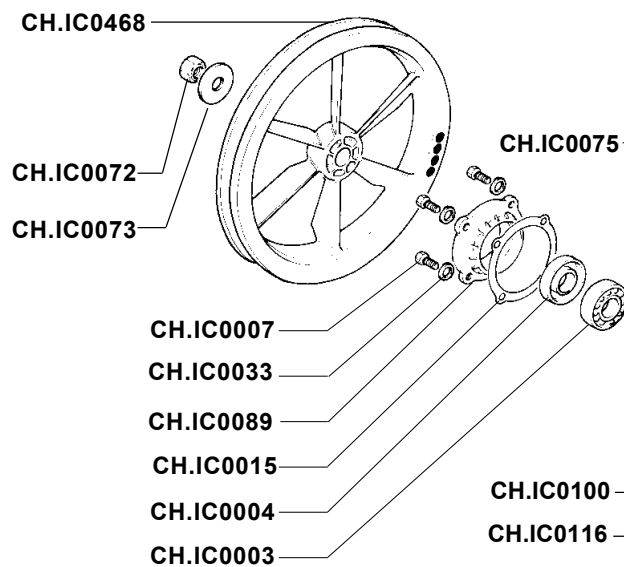
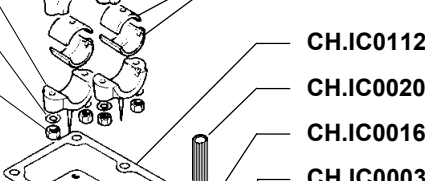
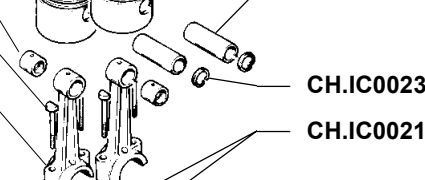
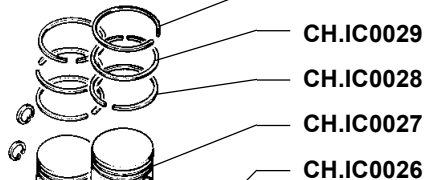
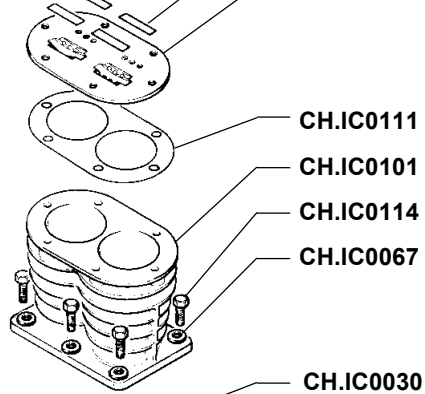
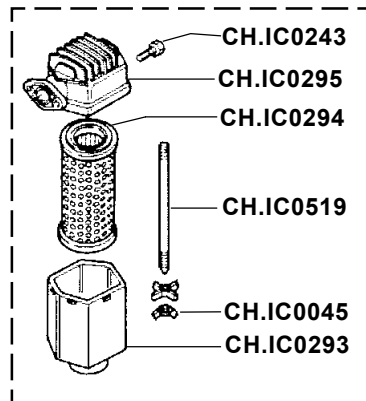
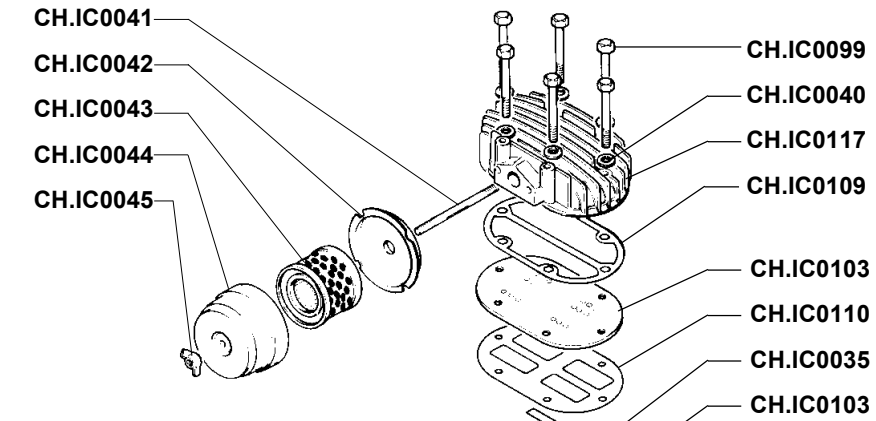
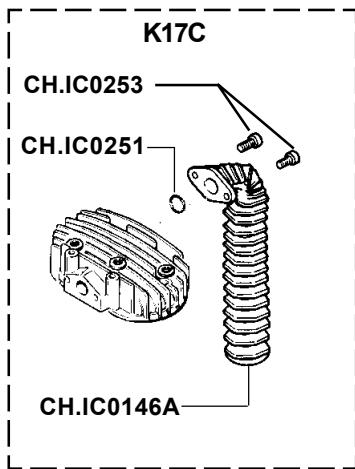

CODE	DENOMINAZIONE	DENOMINATION	DENOMINATION	BEZEICHNUNG	DENOMINACION
CH.IC0003	Cuscinetto	Ball bearing	Roulement à billes	Kugellager	Cojinete
CH.IC0004	Corteco	Bi-angular bearing	Joint	Dichtung	Guarnicion
CH.IC0007	Vite	Screw	Vis	Schraube	Tornillo
CH.IC0011	Tappo olio	Oil plug	Bouchon de vidage	Ölschraube	Tapòn aceite
CH.IC0013	Guarnizione	Gasket	Joint	Dichtung	Empaquetadura
CH.IC0014	Livello olio	Oil sight gauge	Jauge d'huile	Ölstand	Nivel aceite
CH.IC0015	Guarnizione	Gasket	Joint	Dichtung	Empaquetadura
CH.IC0016	Guarnizione	Gasket	Joint	Dichtung	Empaquetadura
CH.IC0016A	Guarnizione	Gasket	Joint	Dichtung	Empaquetadura
CH.IC0020A	Tappo olio	Oil plug	Bouchon de remplissage	Ölschraube	Tapòn aceite
CH.IC0021	Guscio	Bearing shell	Coussin pied de bielle	Lagerschale	Colchòn
CH.IC0022	Dado	Nut	Ecrou	Mutter	Dado
CH.IC0023	Seeger	Circlip	Seeger	Seegerring	Seeger
CH.IC0024	Boccola	Bush	Douille	Buchse	Bullon
CH.IC0025	Vite	Screw	Vis	Schraube	Tornillo
CH.IC0026	Spinotto	Piston pin	Axe du piston	Bolzen	Eje de la biela
CH.IC0027	Pistone ø64	piston ø64	Piston ø64	Kolben ø64	Piston D. 64
CH.IC0028	Raschia olio a feritoia	Slotted oil scraper ring	Segment racleur	Ölanstreifring	Segmento colector
CH.IC0029	Raschia olio a scalino	Stepped scraper ring	Segment huileur	Ölabstreifring	Segmento aceite
CH.IC0030	Anello di compress.	Compression ring	Anneau de compres.	Kolbenring	Anillo de compresion
CH.IC0031	Rondella	Washer	Rondelle	Beilagscheibe	Arandela
CH.IC0033	Rondella	Washer	Rondelle	Beilagscheibe	Arandela
CH.IC0035	Valvola	Valve	Clapet	Ventil	Valvula
CH.IC0040	Rondella	Washer	Rondelle	Beilagscheibe	Arandela
CH.IC0041	Tirante	Tension rod	Tirant	Spannstange	Tirante
CH.IC0042	Coperchio filtro	Filter cover	Couvercle filtre	Deckel	Tapa filtro
CH.IC0043	Cartuccia filtro	Filter cartridge	Cartouche filtre	Filtereinsatz	Cartucho filtro
CH.IC0044	Corpo filtro	Filter casing	Corps filtre	Filtergehäuse	Cuerpo filtro
CH.IC0045	Dado	Nut	Ecrou	Mutter	Dado
CH.IC0067	Rondella	Washer	Rondelle	Beilagscheibe	Arandela
CH.IC0072	Dado	Nut	Ecrou	Mutter	Dado
CH.IC0073	Rondella	Washer	Rondelle	Beilagscheibe	Arandela
CH.IC0075	Biella completa	Compl. connecting rod	Bielle complète	Pleuelstange Komplet	Biela completa
CH.IC0083	Supporto	Support	Support	Lagerflansch	Apoyo
CH.IC0089	Supporto	Support	Support	Lagerflansch	Apoyo
CH.IC0099	Vite	Screw	Vis	Schraube	Tornillo
CH.IC0100	Albero a gomiti	Crankshaft	Vilebrequin	Kurbelwelle	Arbol a codo
CH.IC0101	Cilindro	Cylinder	Cylindre	Zylinder	Cilindro
CH.IC0103	Piastra valvole	Valves plate	Plaque clapets	Ventilplatte	Placa valvulas
CH.IC0109	Guarnizione	Gasket	Joint	Dichtung	Empaquetadura
CH.IC0110	Guarnizione	Gasket	Joint	Dichtung	Empaquetadura
CH.IC0111	Guarnizione	Gasket	Joint	Dichtung	Empaquetadura
CH.IC0112	Guarnizione	Gasket	Joint	Dichtung	Empaquetadura
CH.IC0114	Vite	Screw	Vis	Schraube	Tornillo
CH.IC0116	Monoblocco	Crankcase	Monobloc	Zylinderblock	Monobloque
CH.IC0117	Testata	Cylinderhead	Culasse	Zylinderkopf	Cabeza
CH.IC0468	Volano ø320	Flywheel ø320	Poulie ø320	Schwungrad ø320	Volante D.320
<b>OPTIONAL COLLETTORE</b>					
CH.IC0251	O-Ring	O-Ring	O-Ring	O-Ring	O-Ring
CH.IC0146A	Collettore di scarico	After cooler	Collecteur d'echappement	Nachkühler	Colector de descargo
CH.IC0253	Vite	Screw	Vis	Schraube	Tornillo
<b>OPTIONAL FILTRO EXA</b>					
CH.IC0293	Corpo filtro	Filter casing	Corps filtre	Filtergehäuse	Cuerpo filtro
CH.IC0294	Cartuccia filtro	Filter cartridge	Cartouche filtre	Filtereinsatz	Cartucho filtro
CH.IC0295	Coperchio filtro	Filter cover	Couvercle filtre	Filter Deckel	Tapa filtro
CH.IC0243	Vite	Screw	Vis	Schraube	Tornillo
CH.IC0519	Tirante	Tension rod	Tirant	Spannstange	Tirante
CH.IC0045	Dado	Nut	Ecrou	Mutter	Dado

# K 17 (Dati tecnici / Technical data / Données techniques)

Modello / Model / Modèle		K 17	K 17C
Cilindrata Swept volume Cylindrée	cm <sup>3</sup>	321	321
Motore Motor Moteur	Hp.	2	3
Aria Aspirata Displacement Air aspiré	l/min c.f.m.	321 11,33	449 15,65
Aria Resa Air Delivered Air débité	l/min c.f.m.	231 8,15	314 11,08
Giri/min. Rpm tr/min		1000	1400
Cilindri Cylinders Cylindres		2	2
Pistone BP LP Piston Piston BP	Ø mm inch	64 2,61	64 2,61
Corsa Stroke Course	mm Inch	50 1,97	50 1,97
Pressione max. Max pressure Pression maxi	Bar psi	8 ÷ 10 116 ÷ 145	8 ÷ 10 116 ÷ 145
Ø Volano Flywheel Ø Ø Volant	mm inch	320 12,60	320 12,60
N° Gole / Tipo Groove n. / Type Nombre de gorges / Type		1/A	1/A

Dimensioni / Dimensions		K 17	K 17C
A	mm inch	132 5,19	132 5,19
B	mm inch	100 3,94	100 3,94
C	mm inch	180 7,08	180 7,08
D	mm inch	260 10,24	260 10,24
E	mm inch	320 12,6	320 12,6
F	mm inch	360 14,17	360 14,17
H	mm inch	350 13,77	350 13,77
Peso Weight Poids	Kg lb	14,9 32,85	15,4 33,96
<p>Equivalent legend: 1 inch = 25.4 mm; 1 cfm = 28,317 lt/min.; 1 bar = 14,5 psi; 1 Kg=2,205 lb.</p> <p>Tutti i dati sono garantiti ± 5% All performance data guaranteed ± 5% Toutes les données sont garanties ± 5%</p> <p>La ditta si riserva di cambiare qualsiasi elemento senza alcun preavviso. The company reserves the right to alter any element without notice. La maison se réserve le droit de changer n'importe quel élément sans préavis.</p>			

