

## EXPLODED VIEW

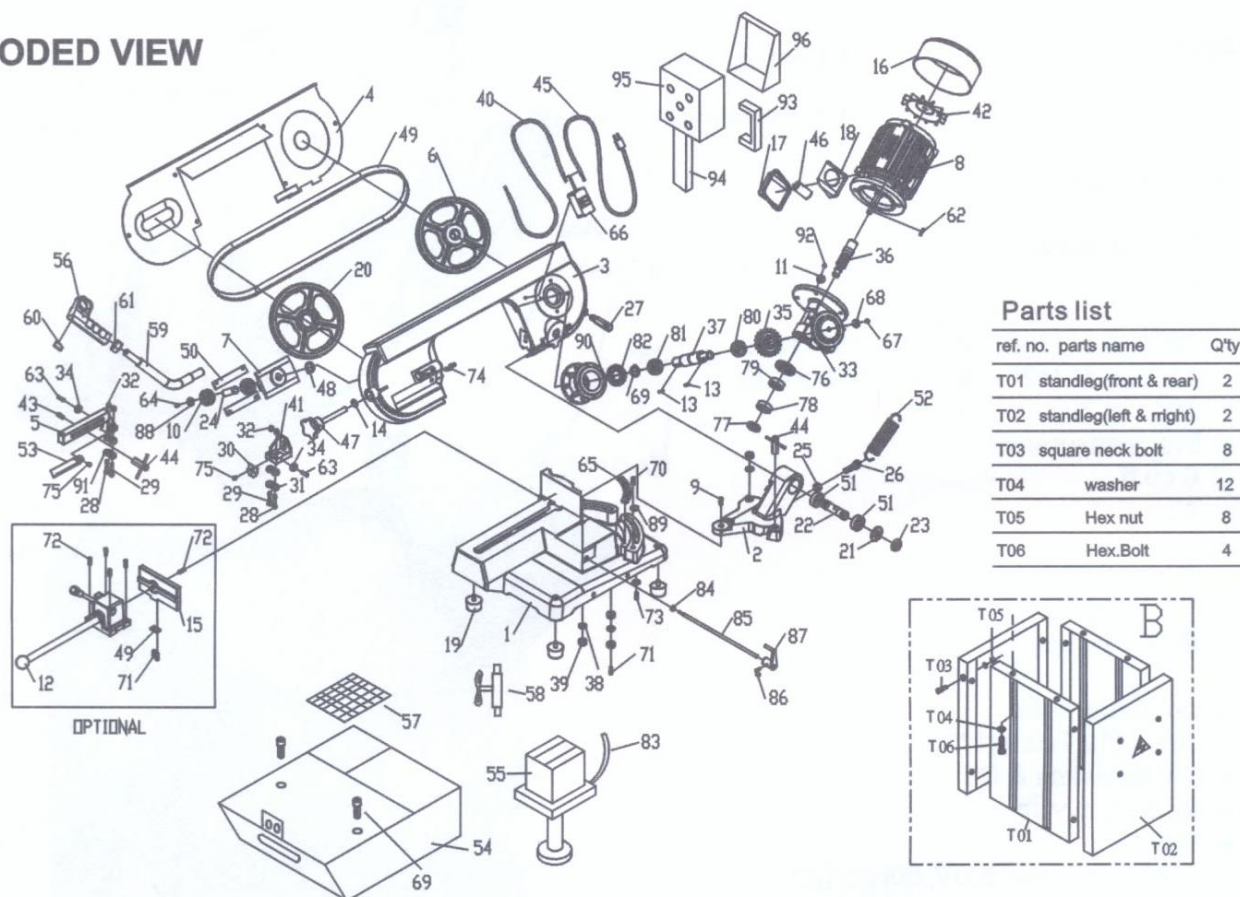

### Parts list

ref. no.	parts name	Q'ty
T01	standleg(front & rear)	2
T02	standleg(left & right)	2
T03	square neck bolt	8
T04	washer	12
T05	Hex nut	8
T06	Hex.Bolt	4

## DELIVERING OF SPARE PARTS

**Please note:** When ordering spare parts please always mention:Model of the machine, Serial number and Reference number of the part  
**SHOULD REF. NUMBERS MISSING, NO SPARE PART WILL BE DELIVERED.**

## LIST OF SPARE PARTS

No.	Q'ty	Description	No.	Q'ty	Description	No.	Q'ty	Description
1	1	Base 本座	33	1	Transmission gear set 渦輪組	65	1	Scale 角度尺
2	1	Miter plate 旋轉盤	34	2	Bearing 培林	66	1	Switch 開關
3	1	Body frame 鋸弓	35	1	Transmission gear 渦輪	67	1	Screw 螺絲
4	1	Body cover 弓蓋	36	1	Worm gear 渦桿	68	2	Washer 華司
5	1	Arm 長支架	37	1	Axis 主軸	69	1	Screw 螺絲
6	1	Motor flywheel 下鋸輪	38	2	Washer 華司	70	2	Screw 螺絲
7	1	Block blade tension 滑塊	39	2	Nut 螺帽	71	2	Screw 螺絲
8	1	Motor 馬達	40	1	Electrical cable 電線	72	4	Screw 螺絲
9	1	Pin 旋轉軸	41	1	Fixed blade guide plate 培林座	73	1	Screw 螺絲
10	2	Bearing 培林	42	1	Motor fan 馬達風扇	74	2	Screw 螺絲
11	1	Gasket 墊片	43	1	Screw 螺絲	75	1	Screw 螺絲
12	1	Quick grip vise 快速夾具	44	1	Bolt 栓頭	76	1	Oil seal 25x37x7# 25x37x7#油封
13	1	key 鍵	45	1	Electrical cable 電源線	77	1	Oil seal 35x7# 35x7#油封
14	1	Washer 華司	46	1	Condenser 電容器	78	1	Bearing 6202# 6202#培林
15	1	Vice jaw 45前檔盤	47	1	Handwheel 鋸片調整栓	79	1	Bearing 6805# 6805#培林
16	1	Motor rear cover 後馬達蓋	48	1	C-ring "C"型扣	80	1	Bearing 6006# 6006#培林
17	1	Cable cover,up 出口線蓋上	49	1	Saw blade 鋸片調整栓	81	1	Bearing 6006# 6006#培林
18	1	Cable cover,down 出口線蓋下	50	1	Block 固定板	82	1	Oil seal 30x55x8# 30x55x8#油封
19	4	Pad 腳墊	51	1	32004 bearing 培林	83	1	Water Pipe 水管
20	1	Return flywheel 上鋸輪	52	1	Spring 彈簧	84	1	Nut M10 螺帽
21	1	washer華司	53	1	L. Blade guard 保護片	85	1	Rod stock stop 長度桿
22	1	Axis主軸	54	1	Base 本座	86	1	Butterfly screw 蝶螺絲
23	1	Nut 螺帽	55	1	Pump 幫浦	87	1	Stock 長度板
24	1	Blade sheet shaft 上鋸輪軸	56	1	Handle 手柄	88	1	Gasket 墊片
25	1	Nut 螺帽	57	1	Web 鐵網	89	1	Eccentric washer 偏心華司
26	1	Spring connection 拉鉤	58	1	Valve 水閥	90	1	Gear base 齒輪箱座
27	1	Spring axis 彈簧軸	59	1	Handle shelf 手柄架	91	1	Bearing 607# 607#培林
28	2	Bias axis 偏心軸	60	1	Micro switch 微動開關	92	1	Screw 螺絲
29	2	Bias axis 偏心軸	61	1	Nut 螺帽	93	1	Handle 手把
30	1	rust plate 前檔片	62	1	4mm key 鍵	94	1	Bracket 支架
31	8	Bearing 607#培林	63	1	Pin 插銷	95	1	Switch Set 整組開關
32	4	Nut 螺帽	64	1	Screw 螺絲	96	1	Fixed Seat 固定座