



Spareparts



MAGNEETBOORMACHINE MD 750/4
FOREUSE MAGNETIQUE MD 750/4

CE

Bestelnr./N° de cde. 40095

MD 750/4

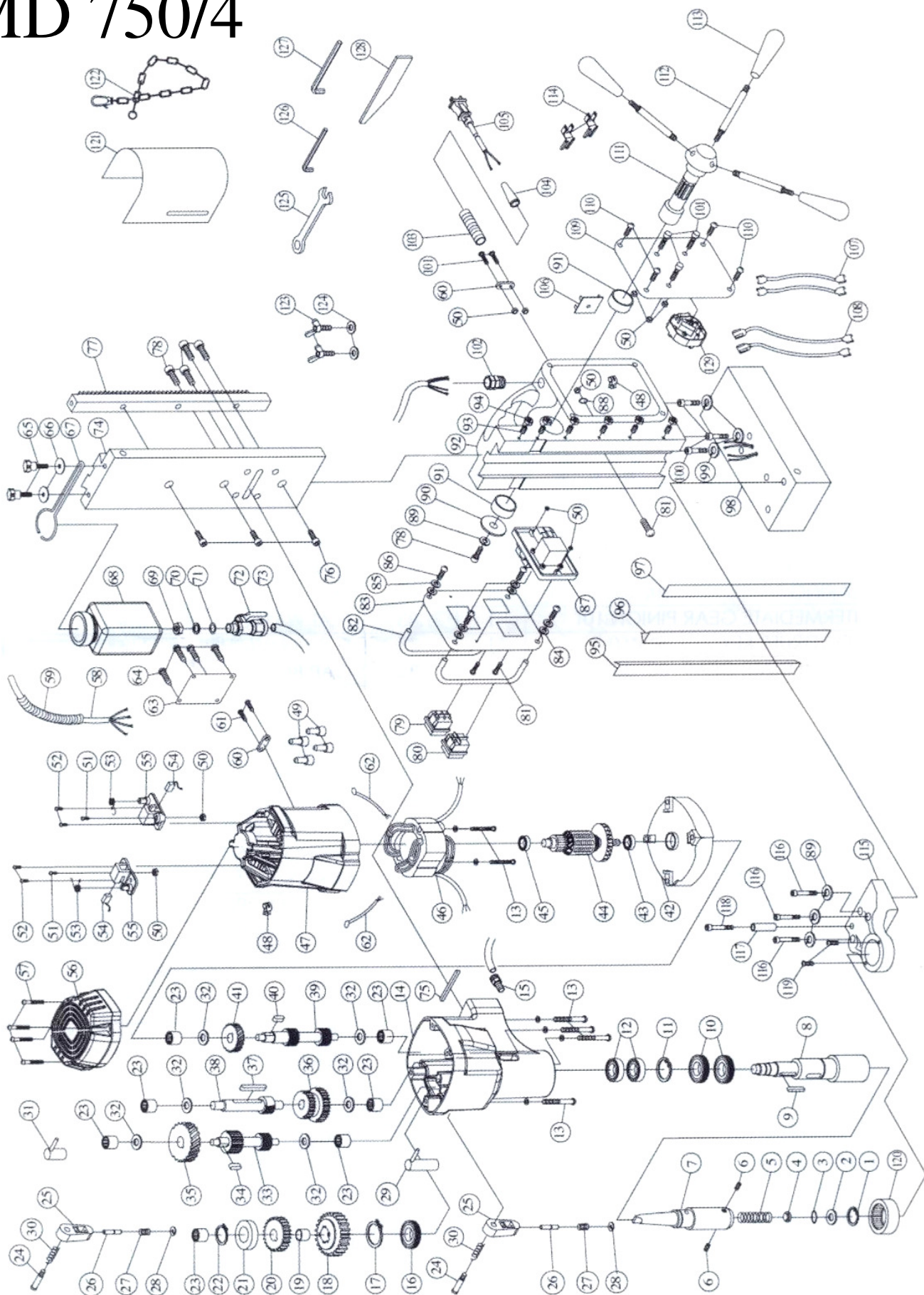

Item No.	Parts Name	Q'TY	Item No.	Parts Name	Q'TY
1	INTERNAL CIR CLIP R-19	1	65	THUMB SCREW	2
2	ARBOR WASHER	1	66	FLAT WASHER M5	2
3	RING 12*4	1	67	COOLANT TANK BRACKET	1
4	WATER SEAL	1	68	COOLANT TANK 400CC	1
5	SPRING	1	69	BRASS NUT	1
6	SET SCREW M8*7	2	70	FLAT WASHER 10*23*2	1
7	MT3 ARBOR	1	71	O-RING 10.7*2	1
8	SPINDLE	1	72	COOLANT TAP	1
9	WOODRUFF KEY 5*5*40	1	73	COOLANT TUBE	1
10	OIL SEAL 40*55*7	2	74	SLIDE PLATE	1
11	INTERNAL CIR CLIP R-55	1	75	WOODRUFF KEY M4*4*30	1
12	BEARING 6006zz	2	76	CAP BOLT M8*20	3
13	SCREW M5*60	6	77	GEAR RACK	1
14	GEAR CASE	1	78	CAP BOLT M8*16	5
15	COOLANT INLET	1	79	REVERSING SWITCH	1
16	OIL SEAL 30*45*5	1	80	MAGNET SWITCH	1
17	EXTERNAL CIR CLIP S-30	1	81	SCREW M4*12	3
18	LOW SPINDLE GEAR 21T	1	82	GUARD BAR	2
19	BUSHING 18*20*11.5	1	83	SWITCH PANEL	1
20	HIGH SPINDLE GEAR 25T	1	84	FLAT WASHER M4	4
21	SPACER	1	85	SPRING WASHER M4	4
22	INTERNAL CIR CLIP S-14	1	86	CAP BOLT M4*16	4
23	BEARING HK1010	7	87	MOTOR SWITCH	1
24	SELECTOR SCREW	2	88	SUN WASHER M5	1
25	SELECTOR TAB	2	89	SPRING WASHER M8	4
26	DETENT PIN	2	90	FLAT WASHER ϕ 40*8*2.5	1
27	SPRING	2	91	BUSHING 32*38*12	2
28	E-CLIP	2	92	STAND BODY	1
29	FIRST SELECTOR FORK	1	93	SET SCREW M5*25	6
30	SPRING	2	94	NUT M5	6
31	SECOND SELECTOR FORK	1	95	GIB STRIP-LEFT	1
32	THRUST WASHER 1024	6	96	GIB STRIP-RIGHT	1
33	LAY SHAFT 16T.7T	1	97	GIB STRIP TENSIONER	1
34	WOODRUFF KEY 5*5*10	1	98	MAGNET	1
35	LAY GEAR S45C	1	99	SPRING WASHER M6	3
36	INTERMEDIATE GEAR 20T.30T	1	100	CAP BOLT M6*20	3
37	WOODRUFF KEY 5*5*50	1	101	SCREW M4*25	5
38	COUNTERSHAFT PINION 12T	1	102	CABLE GLAND	1
39	MAIN SHAFT PINION 10T.12T	1	103	STRAIN RELIEF	1
40	WOODRUFF KEY 5*5*8	1	104	CORD ARMOR	1
41	INPUT GEAR 29T	1	105	POWER SUPPLY CABLE	1
42	GEAR PLATE	1	106	RECTIFIER & EMC	1
43	BEARING 6202 2RS	1	107	WIRE LEADS	2
44	ARMATURE	1	108	WIRE LEADS	2
45	BEARING 6200zz	1	109	SIDE COVER	1
46	STATOR	1	110	SCREW M4*8	4
47	MOTOR HOUSING	1	111	CRANK SPINDLE	1
48	CABLE CLAMP	2	112	CRANK HANDLE	3
49	WIRE CONNECTOR C4	4	113	HANDLE GRIP	3
50	NUT M4	10	114	WIRE CONNECTOR	2
51	SCREW M4*10	2	115	ARBOR SUPPORT BRACKET	1
52	SCREW M4*12	4	116	CAP BOLT M8*25	3
53	BRUSH SPRING	2	117	TRAVEL STOP	1
54	CARBON BRUSH 7*17	2	118	CAP BOLT M6*40	1
55	BRUSH HOLDER 7*17	2	119	SCREW M4*6	2
56	MOTOR TAIL COVER	1	120	BEARING HK3516	1
57	SCREW 4*20	4	121	CHIP GUARD	1
58	MOTOR CABLE	1	122	SAFETY CHAIN	1
59	CABLE PROTECTOR	1	123	BUTTERFLY SCREW M6*10	2
60	CORD CLIP	2	124	FLAT WASHER M6	2
61	SCREW M4*14	2	125	WRENCH M8	1
62	WIRE LEADS	2	126	HEX. KEY M2-5	1
63	MOTOR COVER PLATE	1	127	HEX. KEY M4	1
64	SCREW M5*10	4	128	DRIFT	1