

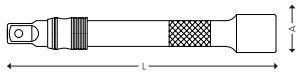

5212 EXQR 1/2" EXTENSIONS WITH QUICK-RELEASE

ISO 3316, DIN 3123.

- Surface: Satin chrome finish. Material: Chrome-vanadium steel.



ITEM NO.	5704196+	L MM	A MM	G	
5212-2075	027777	75	22	128	10
5212-2125	027784	125	22	212	10
5212-2250	027791	250	22	418	10

5212 EXW 1/2" WOBBLE EXTENSIONS

- Can be used for both wobble and rigid functionality.
- The wobble function provides 15° of additional accessibility.
- With ext. 22 mm Hexagon.
- Surface: Satin chrome finish. Material: Chrome-vanadium steel.

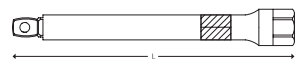

ITEM NO.	5704196+	L MM	A MM	G	
5212-1075	011066	75	24	160	10
5212-1125	011073	125	24	247	10
5212-1150	011080	150	24	280	10
5212-1250	021959	250	24	420	10
5212-1500	011097	500	24	850	10

5290 1/2" QUICK-RELEASE EXTENSION BAR SET

- Supplied in nylon bag.



ITEM NO.	5704196+	QTY.	SIZE MM	G	
5290-1203	027814	3	5212 EXQR 75 mm, 125 mm, 250 mm	850	1

5712 A 1/2" ADAPTOR FROM 1/2" TO 3/8"

ISO 3316, DIN 3123

- Surface: Satin chrome finish. Material: Chrome-vanadium steel.

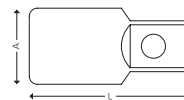

ITEM NO.	5704196+	□	■	A MM	L MM	G	
5712-1238	003467	1/2"	3/8"	22	36	67	10

5612 A 1/2" ADAPTOR FROM 1/2" TO 3/4"

ISO 3316, DIN 3123

- Surface: Satin chrome finish. Material: Chrome-vanadium steel.

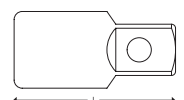

ITEM NO.	5704196+	□	■	A MM	L MM	G	
5612-1234	003474	1/2"	3/4"	25	50	140	10

