



# POLAR® SOCKETS AND ACCESSORIES



## 5214 EX 1/4" EXTENSIONS

ISO 3316, DIN 3123.

- With ext. 11 mm hexagon.
- Surface: Satin chrome finish. Material: Chrome-vanadium steel.



ITEM NO.	5704196+	L MM	A MM	G	10
5214-0050	001562	50	12	26	10
5214-0100	001579	100	12	48	10
5214-0150	001586	150	12	70	10

## 5614 A 1/4" ADAPTOR FROM 1/4" TO 3/8"

ISO 3316, DIN 3123

- Surface: Satin chrome finish. Material: Chrome-vanadium steel.

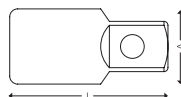

ITEM NO.	5704196+	1/4"	3/8"	A MM	L MM	G	10
5614-1438	001609	1/4"	3/8"	14	25,5	32	10

## 5214 EX 1/4" EXTENSION WITH QUICK-RELEASE

ISO 3316, DIN 3123

- Surface: Satin chrome finish. Material: Chrome-vanadium steel.

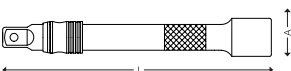

ITEM NO.	5704196+	L MM	A MM	G	10
5214-2250	027739	250	12,3	90	10

## 5414 TH 1/4" SLIDING T-HANDLE

ISO 3315, DIN 3122

- Surface: Satin chrome finish. Material: Chrome-vanadium steel.

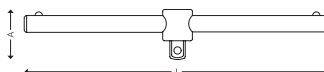

ITEM NO.	5704196+	L MM	A MM	G	10
5414-0014	001623	115	24	42	10

## 5214 F 1/4" FLEXIBLE EXTENSION

- Maximum torque allowed: 2,8 Nm.
- Surface: Chrome plated finish. Material: Chrome-vanadium steel.

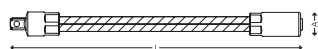

ITEM NO.	5704196+	L MM	A MM	G	10
5214-1150	001593	150	12	62	10

## 5814 U 1/4" UNIVERSAL JOINT

ISO 3316, DIN 3123

- Equipped with tension-spring. Joint stays at desired angle.
- Surface: Satin chrome finish. Material: Chrome-vanadium steel.

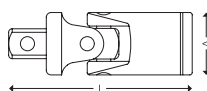

ITEM NO.	5704196+	L MM	A MM	G	10
5814-0014	001616	38	14	27	10